



Cabinets, Countertops, and Accessories





Certificate Number: 24089
Issue Date: September 16, 2024
Expiration Date: August 31, 2025
Supersedes Certificate No.: 23093

LISTING
CERTIFICATE

THIS CERTIFIES THAT

Astera, Inc.

Atlanta, GA

is a current participant in the Kitchen Cabinet Manufacturers Association Certification Program and is manufacturing the following lines of kitchen cabinets and/or bathroom vanity cabinets in conformance with American National Standard ANSI/KCMA A161.1-2022, *Performance and Construction Standard for Kitchen and Vanity Cabinets*:

Framed Cabinets with Shaker Doors
Frameless Cabinets with Thermofoil and Melamine Doors

These cabinet lines are listed in the Kitchen Cabinet Manufacturers Association Directory of Certified Cabinet Manufacturers. This manufacturer is authorized to apply KCMA Certification Seals to the kitchen and bath cabinet lines listed above. Flat pack (unassembled) cabinets, if sold by this manufacturer, are not certified.

This certificate may be updated at any time and will expire on the date listed above. This certificate may also be canceled for non-conformity with the requirements of the Certification Program or upon voluntary withdrawal from the program by the manufacturer.

A handwritten signature in blue ink, appearing to read 'CPA'.

Charles P. Arnold
Vice President Standards & Certification

This certificate is current as of the issue date
Current listing information is at www.kcma.org

Astera supplies KCMA certified cabinets at a very competitive price. As a member of the NKBA, we are always up to date with the latest trends and technology in the industry

THIS CERTIFIES THAT

ASTERA, Inc.



* Nationally certified by the: **GEORGIA MINORITY SUPPLIER DEVELOPMENT COUNCIL**

*NAICS Code(s): 423310; 337110; 238350

* Description of their product/services as defined by the North American Industry Classification System (NAICS)

09/27/2024

Issued Date

AT245835

Certificate Number

10/31/2025

Expiration Date

A handwritten signature in black ink, appearing to read "Ying McGuire", is positioned above the printed name.

Ying McGuire
NMSDC CEO and President

A handwritten signature in black ink, appearing to read "Stacey Key", is positioned above the printed name.

Stacey Key, President and CEO

By using your password (NMSDC issued only), authorized users may log into NMSDC Central to view the entire profile: <http://nmsdc.org>

Certify, Develop, Connect, Advocate.

* MBEs certified by an Affiliate of the National Minority Supplier Development Council, Inc.®

Astera, Inc. is a certified Minority Business Enterprise (MBE) by the Georgia Minority Supplier Development Council, recognized nationally by the NMSDC.

CONTENT

About Us	05
Face Frame Cabinets	06
Construction	07
Doors & Color Collection	08
Frameless Cabinets	10
Construction	11
Doors	12
Color Collection	13
Module Cabinets	14
Accessories	20
Filler	20
Base End Panel	20
Refrigerator Panel	20
Crown Moulding	20
Plastic Leg	20
Aluminium Toekick	20
Toekick Panel	20
Toekick Skin	20
PVC TOE KICK	21
Pull Out Waste Bin	22
Movable Island	23
Vanity	26
Countertops	29
Granite	30
Quartz	32
Cabinet Hardware	33
Hinges	34
Handles	35
Knobs	36
Drawer Slides	36
Sink & Faucet	38
Kitchen Sink	39
Vanity Sink	40
Kitchen Faucet	41
Vanity Faucet	41
Gallery	42



ABOUT ASTERA

Astera is a manufacturer of kitchen and bathroom cabinets, offering a wide range of styles and finishes at affordable prices. All of our kitchen and bath products are manufactured to provide lasting beauty and service and they are made of the highest quality materials in the industry. Each of our products is tested and inspected to live up to Astera Cabinet's high standards of workmanship, durability, and value.

Our customer service representatives are trained and knowledgeable in the sales and installation aspect of kitchen and bath products. They are available to take your order, answer your questions, or to send you a free catalog of our full inventory. We guarantee you one-on-one customer service and you will receive the full attention you deserve when you place your order with us. Your order will be promptly and professionally handled and shipped to your destination on the day you need it, complete and ready to install.

As the Division of Young Corporation

Astera is a division of Young Corporation Group - a vertically integrated company that provides turnkey interior solutions for multi-family, hospitality, student housing and assisted living sectors. Learn more about the Young Corporation brands and products on www.youngcorporation.com



FACE FRAME CABINETS

www.asterakb.com

FACE FRAME CABINETS CONSTRUCTION

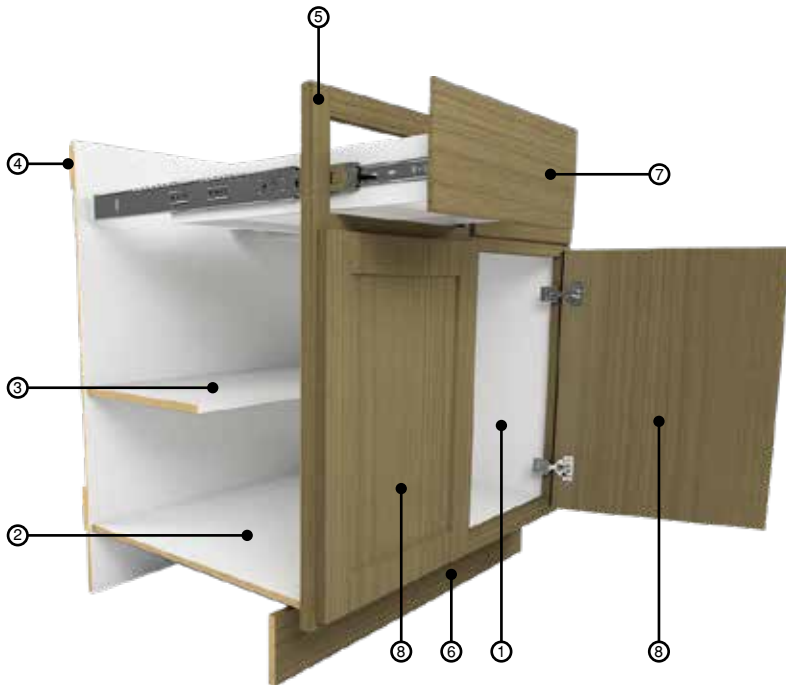

BASE CABINET

1. 1/2" Particle Board Base Right/Left, double side finished
2. 1/2" Particle Board Base Bottom, single side finished
3. 5/8" Particle Board Base Shelf, double side finished with matching PVC edge tape on front
4. 1/4" MDF Back, single side finished with 1/2" unfinished PB supports
5. 3/4" x 1-1/2" face frame
6. 1/2" Particle Board toe kick, single side finished
7. 1/2" PB drawer box with 1/4" MDF drawer bottom, 3/4" drawer front with our standard ball bearing slides.
8. 3/4" door

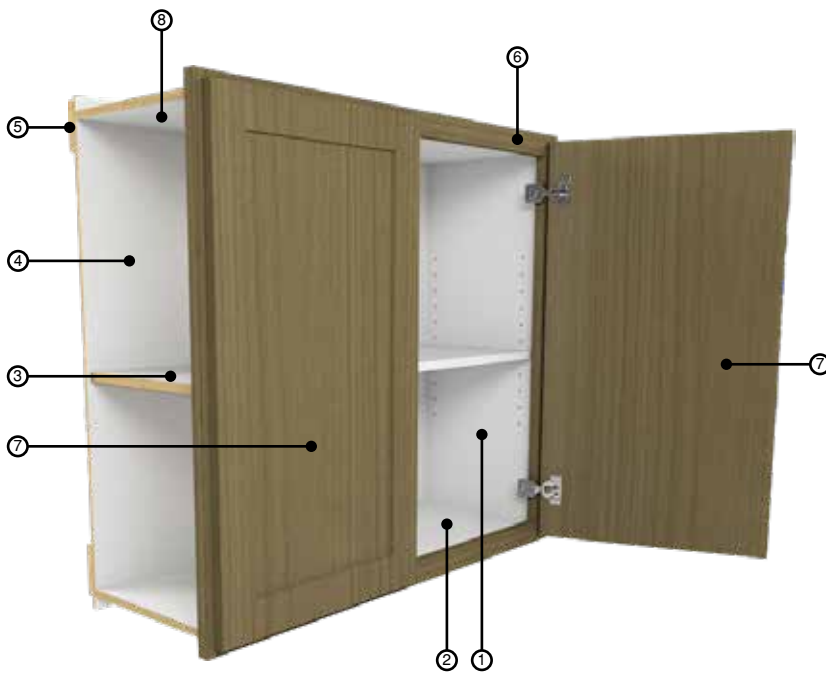

WALL CABINET

1. 1/2" Particle Board Wall Right/Left, double side finished
2. 1/2" Particle Board Wall Bottom, single side finished
3. 5/8" Particle Board Wall shelves, double side finished with matching PVC edge tape on front
4. 1/4" MDF Back, single side finished
5. 1/2" PB support, unfinished
6. 3/4" x 1-1/2" face frame
7. 3/4" door
8. 1/2" Particle Board Upper, single side finished

NOTE: Also available in plywood

FACE FRAME CABINETS DOORS

PAINTED SHAKER DOORS

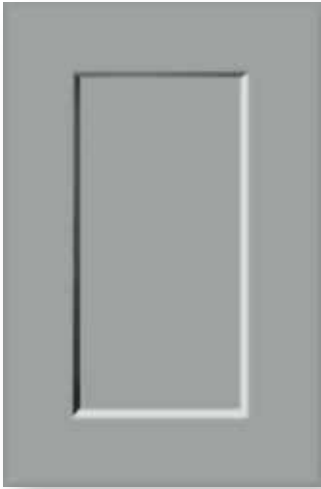

Painted Shaker Door

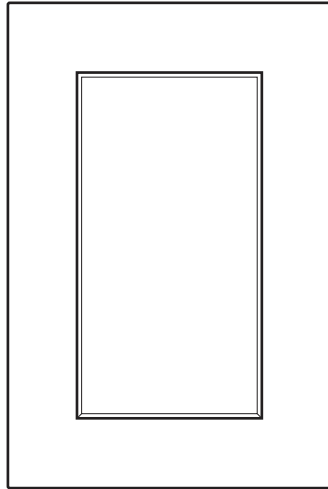

Shaker Door
Front View

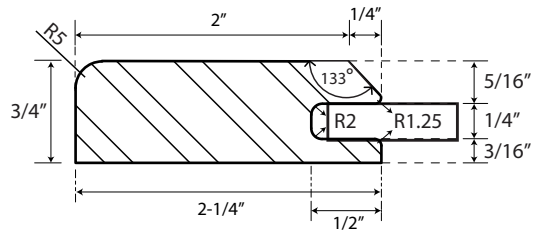

Shaker Door
Profile

PAINTED STRAIGHT SHAKER DOORS



Straight Shaker Door

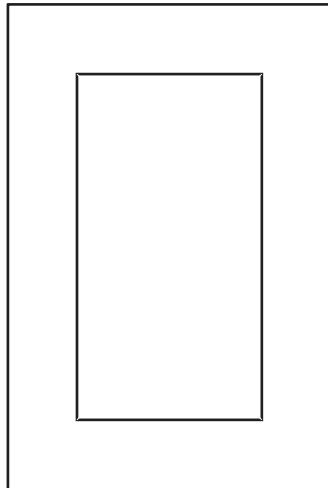

Straight Shaker Door
Front View

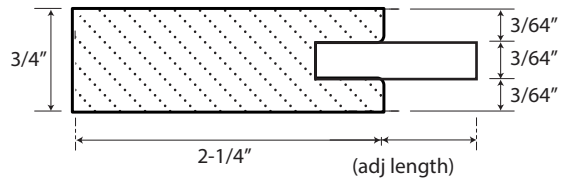

Straight Shaker Door
Profile

FACE FRAME CABINETS DOORS & COLOR COLLECTION

SLIM SHAKER DOORS



Slim Shaker Door

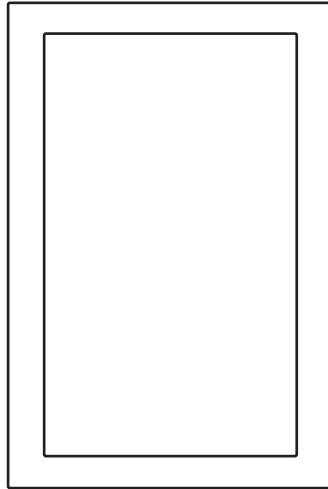

Slim Shaker Door
Front View

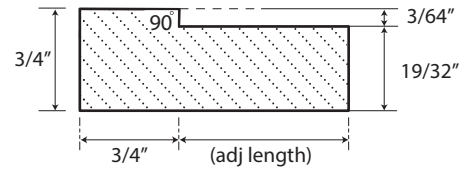

Slim Shaker Door
Profile

Color Options

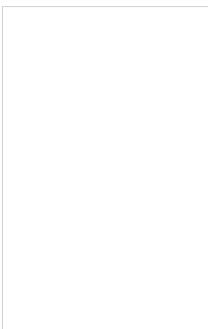

White

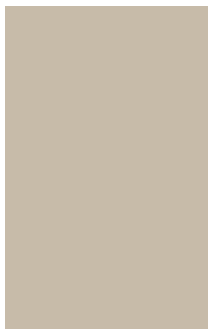

Shiitake

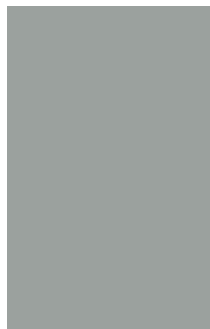

Ventura Gray

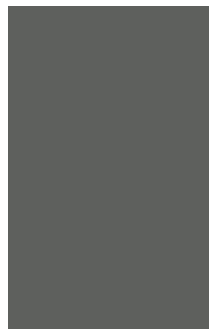

Gauntlet Gray



Gale Force



Black



FRAMELESS CABINETS

www.asterakb.com

FRAMELESS CABINETS CONSTRUCTION

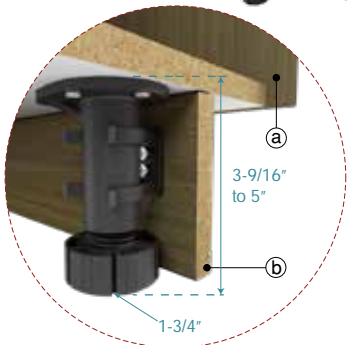
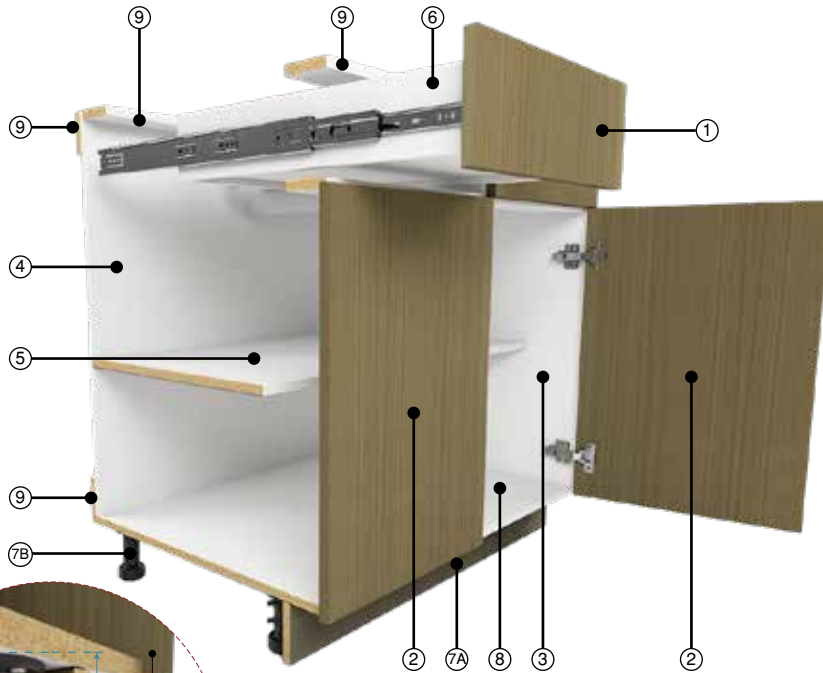

7B) Adjustable Plastic Leg
 a. front of cabinet
 b. toe board

BASE CABINET

1. 3/4" melamine slab drawer front.
2. 3/4" melamine slab door.
3. 5/8" particle board Right/Left, 2 side finished, melamine paper.
4. 1/4" MDF back, 1 side finished, melamine paper.
5. 5/8" particle board shelves with matching PVC Edge tape on front.
6. 5/8" particle board drawer box with 1/4" MDF on bottom.
7. A) 1/2" particle board toe kick, 1 side finished.
 B) Adjustable plastic leg.
8. 5/8" particle board bottom, 1 side finished.
9. Particle board support, finished on exposed edges.

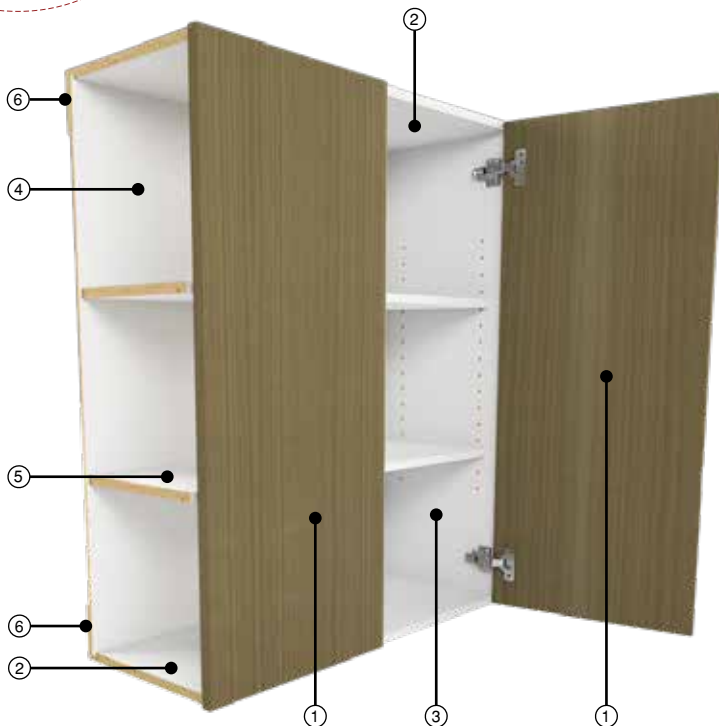

WALL CABINET

1. 3/4" melamine slab door.
2. 5/8" particle board Top / Bottom, 2 side finished, melamine paper.
3. 5/8" particle board Right/Left with 2 side finished, melamine paper.
4. 1/4" MDF back, 1 side finished, melamine paper.
5. 5/8" particle board shelves, with matching PVC edge tape on front
6. Particle board support, unfinished

FRAMELESS CABINETS DOORS

THERMOFOIL SLAB DOORS



Slab Door

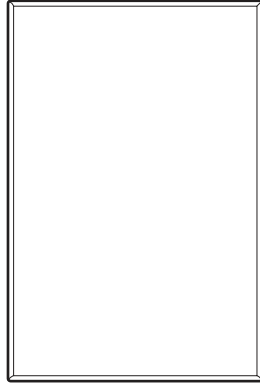

Slab Door Front View

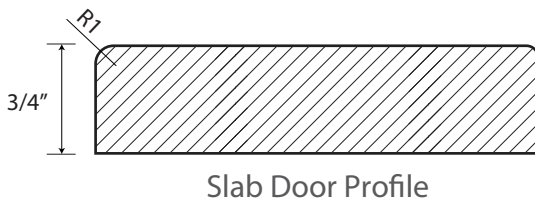

THERMOFOIL SHAKER DOORS

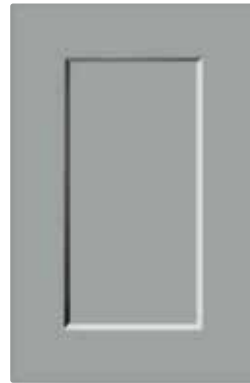

Shaker Door

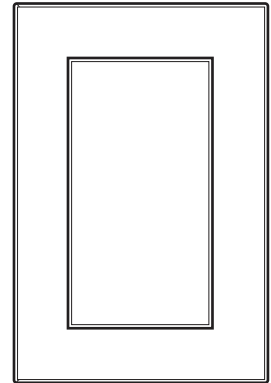

Shaker Door
Front View

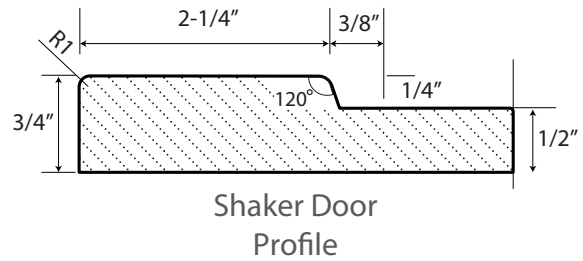

SLIM SHAKER DOORS



Slim Shaker Door

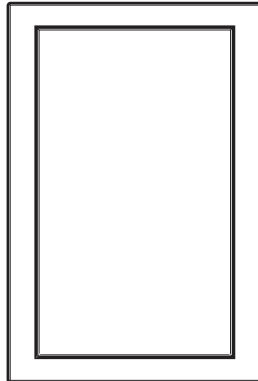

Slim Shaker Door
Front View

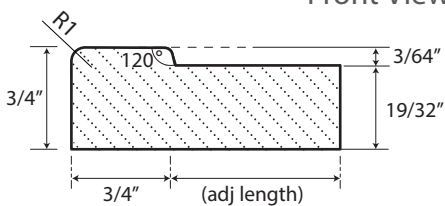

MELAMINE SLAB DOORS



Slab Door

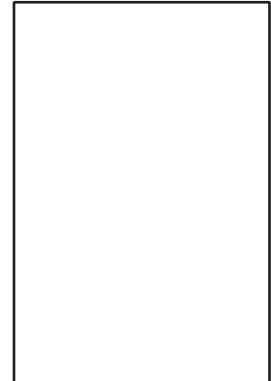

Slab Door

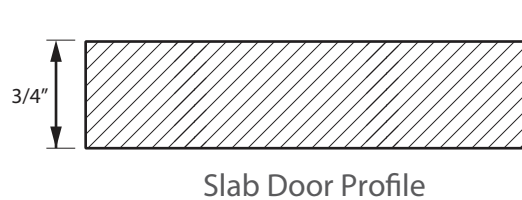

FRAMELESS CABINETS COLOR COLLECTION

Woodgrain Colors - Thermofoil

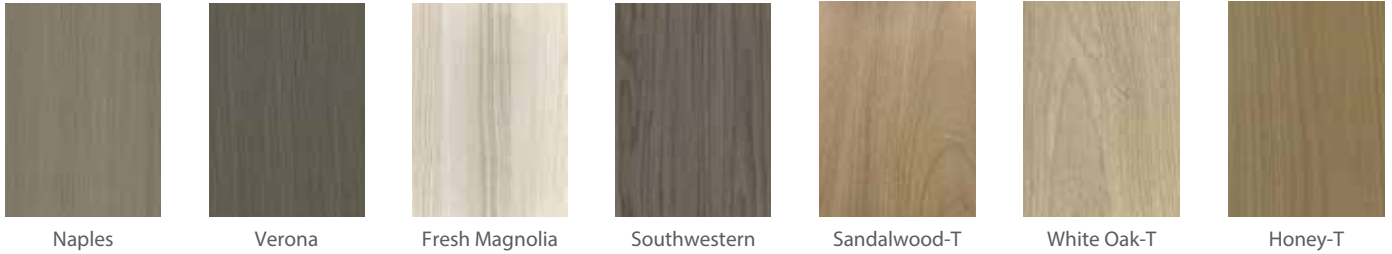

Naples

Verona

Fresh Magnolia

Southwestern

Sandalwood-T

White Oak-T

Honey-T

Solid Colors - Thermofoil



White

Ventura Gray-T

Gale Force-T

Veredian Green-T

Gauntlet Gray-T

Black

Woodgrain Colors - Melamine



Phantom Pearl

Crema

White Oak-M

Concrete

Sandalwood-M

Smith

Ashwood Oak



Warm Teak

Noce Vettore

Portico Teak

Grigio

Licorice

Solid Colors - Melamine

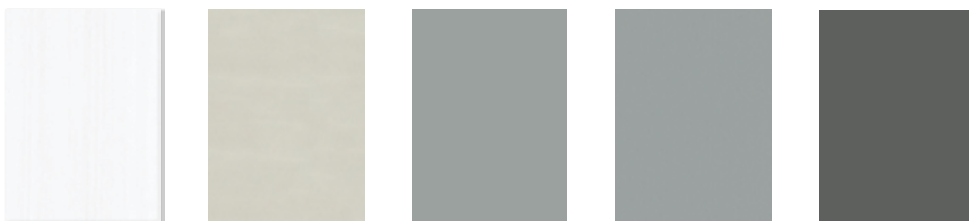

White

Colonnade Gray

Ventura Gray

Solis Gray

Gauntlet Gray-M

MODULE CABINETS

BASE CABINET

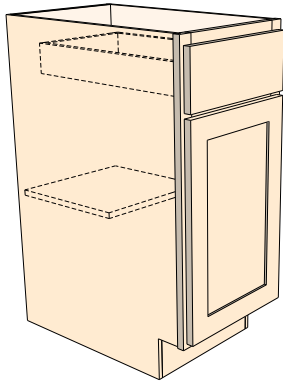

Standard Module

Base Cabinet with 1 Door + 1 Drawer

D= 24", H=34-1/2"
 B 09 (width 9")
 B 12 (width 12")
 B 15 (width 15")
 B 18 (width 18")
 B 21 (width 21")

Handicap Module

Base Cabinet with 1 Door + 1 Drawer

D= 24", H=32-1/2"
 B 09 HC (width 9")
 B 12 HC (width 12")
 B 15 HC (width 15")
 B 18 HC (width 18")
 B 21 HC (width 21")

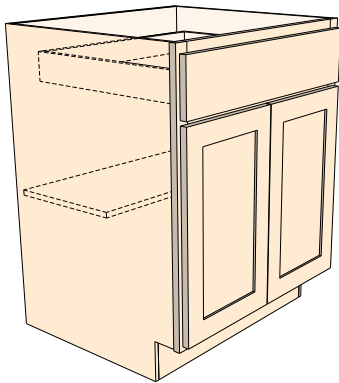

Standard Module

Base Cabinet with 2 Doors + 1 Drawer

D= 24", H=34-1/2"
 B 24 (width 24")
 B 27 (width 27")
 B 30 (width 30")

Handicap Module

Base Cabinet with 2 Doors + 1 Drawer

D= 24", H=32-1/2"
 B 24 HC (width 24")
 B 27 HC (width 27")
 B 30 HC (width 30")

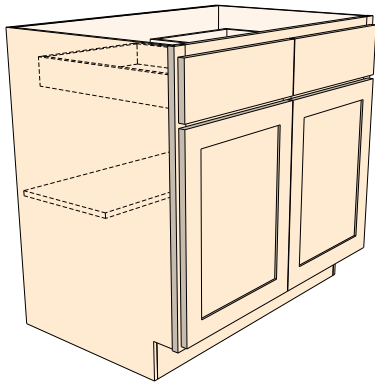

Standard Module

Base Cabinet with 2 Doors + 2 Drawers

D= 24", H=34-1/2"
 B 33 (width 33")
 B 36 (width 36")
 B 39 (width 39")
 B 42 (width 42")
 B 45 (width 45")
 B 48 (width 48")

Handicap Module

Base Cabinet with 2 Doors + 2 Drawers

D= 24", H=32-1/2"
 B 33 HC (width 33")
 B 36 HC (width 36")
 B 39 HC (width 39")
 B 42 HC (width 42")
 B 45 HC (width 45")
 B 48 HC (width 48")

SINK BASE CABINET

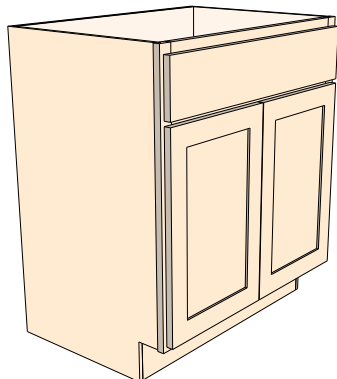

Standard Module

Sink Base Cabinet with 2 Doors + 1 Fixed Drawer

D= 24", H=34-1/2"
 SB 30 (width 30")

Handicap Module

Sink Base Cabinet with 2 Doors + 1 Fixed Drawer

D= 24", H=32-1/2"
 SB 30 HC (width 30")

SINK BASE CABINET

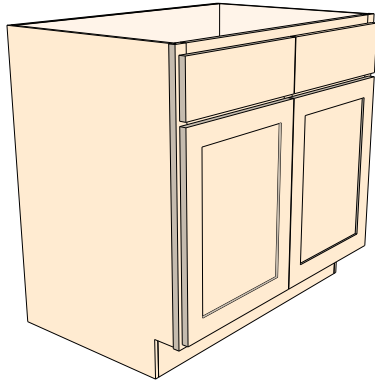

Standard Module

Sink Base Cabinet with 2 Doors + 2 Fixed Drawers

D= 24", H=34-1/2"
 SB 33 (width 33")
 SB 36 (width 36")
 SB 39 (width 39")
 SB 42 (width 42")

Handicap Module

Sink Base Cabinet with 2 Doors + 2 Fixed Drawers

D= 24", H=32-1/2"
 SB 33 HC (width 33")
 SB 36 HC (width 36")
 SB 39 HC (width 39")
 SB 42 HC (width 42")

DRAWER BASE CABINET

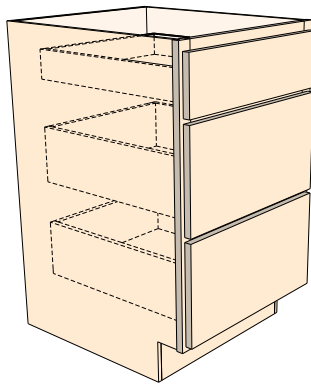

Standard Module

Drawer Base Cabinet with 3 Drawers

D= 24", H=34-1/2"
 DB 09 (width 9")
 DB 12 (width 12")
 DB 15 (width 15")
 DB 18 (width 18")
 DB 21 (width 21")
 DB 24 (width 24")

Handicap Module

Drawer Base Cabinet with 3 Drawers

D= 24", H=32-1/2"
 DB 09 HC (width 9")
 DB 12 HC (width 12")
 DB 15 HC (width 15")
 DB 18 HC (width 18")
 DB 21 HC (width 21")
 DB 24 HC (width 24")

VANITY SINK BASE CABINET

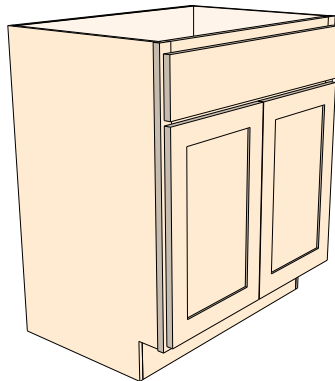

Standard Module

Vanity Sink Base Cabinet with 2 Doors + 1 Fixed Drawer

D= 21", H=34-1/2"
 VSB 24 (width 24")
 VSB 27 (width 27")
 VSB 30 (width 30")

Handicap Module

Vanity Sink Base Cabinet with 2 Doors + 1 Fixed Drawer

D= 21", H=32-1/2"
 VSB 24 HC (width 24")
 VSB 27 HC (width 27")
 VSB 30 HC (width 30")

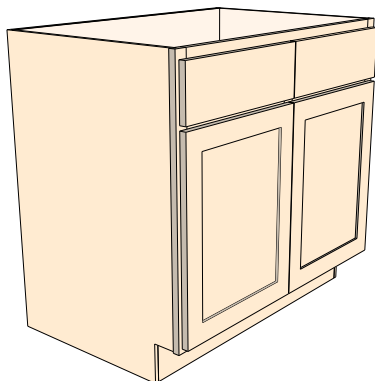

Standard Module

Vanity Sink Base Cabinet with 2 Doors + 2 Fixed Drawers

D= 21", H=34-1/2"
 VSB 33 (width 33")
 VSB 36 (width 36")
 VSB 39 (width 39")
 VSB 42 (width 42")
 VSB 45 (width 45")
 VSB 48 (width 48")

Handicap Module

Vanity Sink Base Cabinet with 2 Doors + 2 Fixed Drawers

D= 21", H=32-1/2"
 VSB 33 HC (width 33")
 VSB 36 HC (width 36")
 VSB 39 HC (width 39")
 VSB 42 HC (width 42")
 VSB 45 HC (width 45")
 VSB 48 HC (width 48")

VANITY DRAWER BASE CABINET

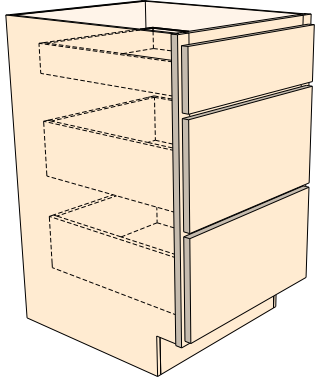

Standard Module

Drawer Base Cabinet with 3 Drawers

D= 21", H=34-1/2"
 VDB 09 (width 9")
 VDB 12 (width 12")
 VDB 15 (width 15")
 VDB 18 (width 18")
 VDB 21 (width 21")
 VDB 24 (width 24")

Handicap Module

Drawer Base Cabinet with 3 Drawers

D= 21", H=32-1/2"
 VDB 09 HC (width 9")
 VDB 12 HC (width 12")
 VDB 15 HC (width 15")
 VDB 18 HC (width 18")
 VDB 21 HC (width 21")
 VDB 24 HC (width 24")

DIAGONAL BASE

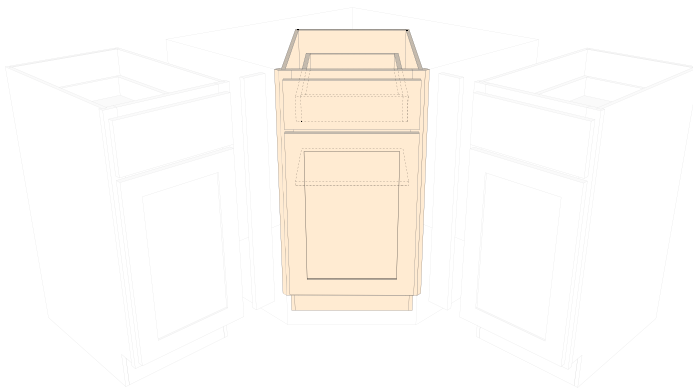

Standard Module

Diagonal Base

D= 24", H=34-1/2"
 DBC 36 (width 36")

Handicap Module

Diagonal Base

D= 24", H=32-1/2"
 DBC 36 HC (width 36")

DIAGONAL DRAWER BASE

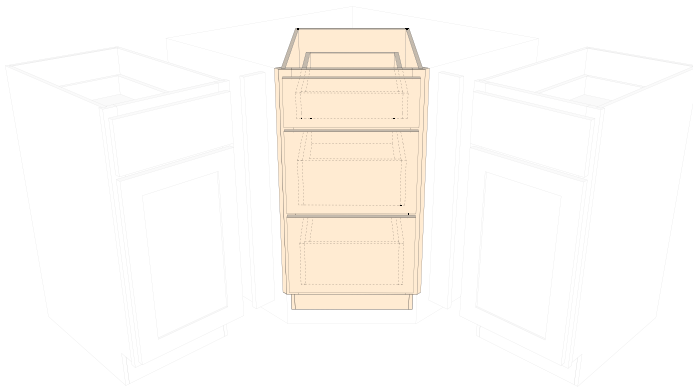

Standard Module

Diagonal Drawer Base Cabinet with 3 Drawers

D= 24", H=34-1/2"
 DDB 36 (width 36")

Handicap Module

Diagonal Drawer Base Cabinet with 3 Drawers

D= 24", H=32-1/2"
 DDB 36 HC (width 36")

BASE CORNER CABINET

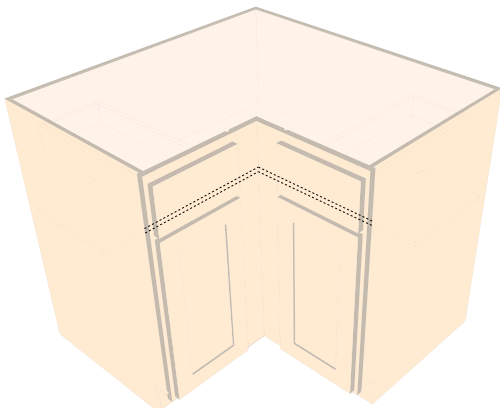

Standard Module

Base Corner Cabinet

D= 24", H=34-1/2"
 BC 36 (width 36")
 BC 39 (width 39")

Handicap Module

Base Corner Cabinet

D= 24", H=32-1/2"
 BC 36 HC (width 36")
 BC 39 HC (width 39")

BLIND BASE CABINET

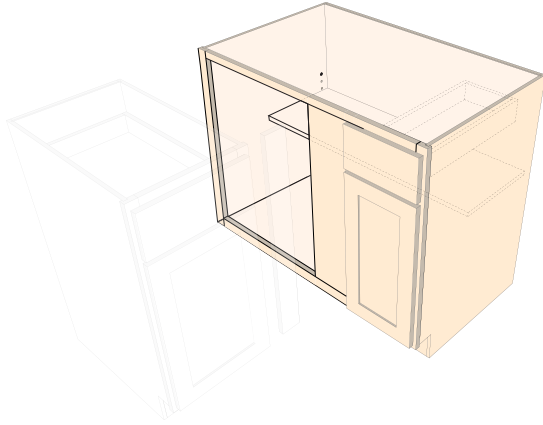

Standard Module

Blind Base Cabinet

D= 24", H=34-1/2"

BB 39 (width 39")

BB 42 (width 42")

BB 45 (width 45")

BB 48 (width 48")

Handicap Module

Blind Base Cabinet

D= 24", H=32-1/2"

BB 39 HC (width 39")

BB 42 HC (width 42")

BB 45 HC (width 45")

BB 48 HC (width 48")

PANTRY / LINEN CABINET

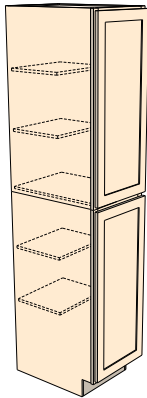

Standard Module

Pantry Cabinet with 2 Doors

XX = 80" / 84" / 90" / 96" (Optional Height)

YY = 12" / 21" / 24" (Optional Depth)

P 09 XX YY (width 9")

P 12 XX YY (width 12")

P 15 XX YY (width 15")

P 18 XX YY (width 18")

P 21 XX YY (width 21")

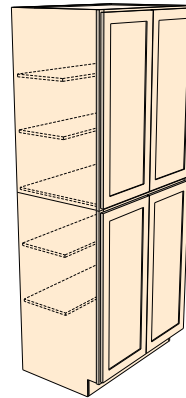

Standard Module

Pantry Cabinet with 4 Doors

XX = 80" / 84" / 90" / 96" (Optional Height)

YY = 12" / 21" / 24" (Optional Depth)

P 24 XX YY (width 24")

P 27 XX YY (width 27")

P 30 XX YY (width 30")

P 33 XX YY (width 33")

P 36 XX YY (width 36")

P 39 XX YY (width 39")

P 42 XX YY (width 42")

P 45 XX YY (width 45")

P 48 XX YY (width 48")

WALL CABINET

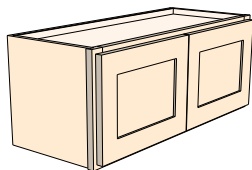

Standard Module

Wall Cabinet with 2 Doors

D= 12"

XX = 12" / 15" (Optional Height)

W 30 XX (width 30")

W 33 XX (width 33")

W 36 XX (width 36")

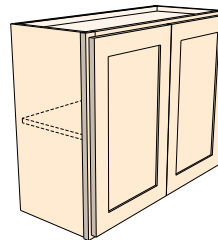

Standard Module

Wall Cabinet with 2 Doors + 1 Shelf

D= 12"

XX = 18" / 24" / 27" (Optional Height)

W 30 XX (width 30")

W 33 XX (width 33")

W 36 XX (width 36")

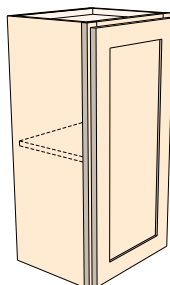

Standard Module

Wall Cabinet with 1 Shelf + 1 Door

D= 12", H= 30"

W 0930 (width 9")

W 1230 (width 12")

W 1530 (width 15")

W 1830 (width 18")

W 2130 (width 21")

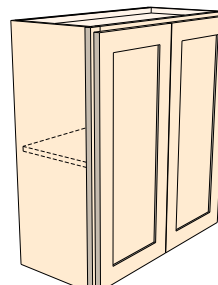

Standard Module

Wall Cabinet with 1 Shelf + 2 Doors

D= 12", H= 30"

W 2430 (width 24")

W 2730 (width 27")

W 3030 (width 30")

W 3330 (width 33")

W 3630 (width 36")

W 3930 (width 39")

W 4230 (width 42")

W 4530 (width 45")

W 4830 (width 48")

WALL CABINET

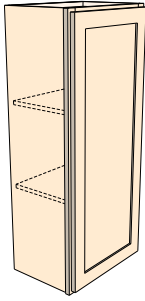

Standard Module

Wall Cabinet with 1 Door + 2 Shelves

D= 12", H= 36"

- W 0936 (width 9")
- W 1236 (width 12")
- W 1536 (width 15")
- W 1836 (width 18")
- W 2136 (width 21")

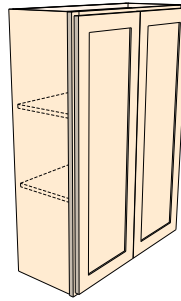

Standard Module

Wall Cabinet with 2 Doors + 2 Shelves

D= 12", H= 36"

- W 2736 (width 27")
- W 3036 (width 30")
- W 3336 (width 33")
- W 3636 (width 36")
- W 4236 (width 42")
- W 4836 (width 48")

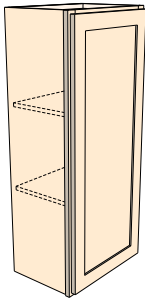

Standard Module

Wall Cabinet with 1 Door + 2 Shelves

D= 12", H= 42"

- W 0942 (width 9")
- W 1242 (width 12")
- W 1542 (width 15")
- W 1842 (width 18")
- W 2142 (width 21")
- W 2442 (width 24")

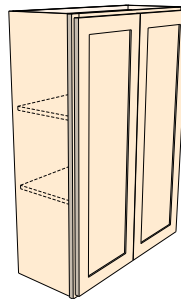

Standard Module

Wall Cabinet with 2 Doors + 2 Shelves

D= 12", H= 42"

- W 2742 (width 27")
- W 3042 (width 30")
- W 3342 (width 33")
- W 3642 (width 36")
- W 4242 (width 42")
- W 4842 (width 48")

DIAGONAL WALL

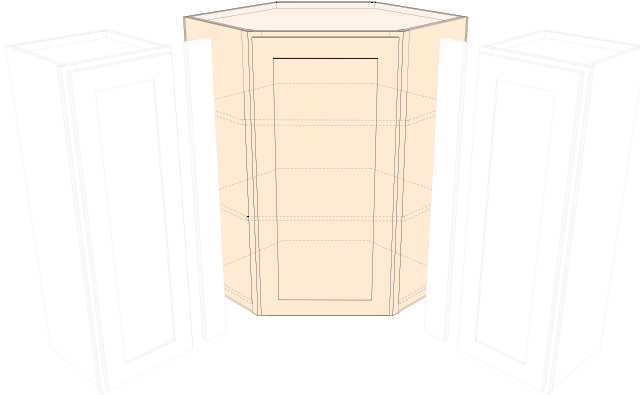

Standard Module

Diagonal Wall Cabinet

D= 12"

XX = 30" / 36" / 42" (Optional Height)

DW 24 XX (width 24")

WALL CORNER CABINET

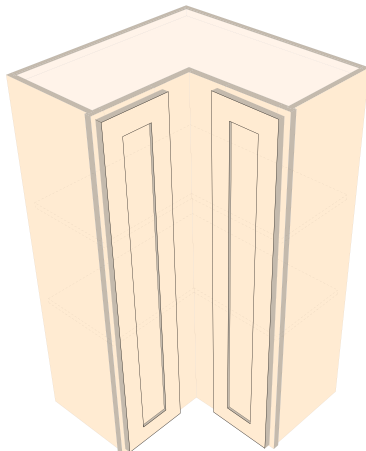

Standard Module

Wall Corner

D= 12"

XX = 30" / 36" / 42" (Optional Height)

WC 24 XX (width 24")

WC 27 XX (width 27")

WINE RACK

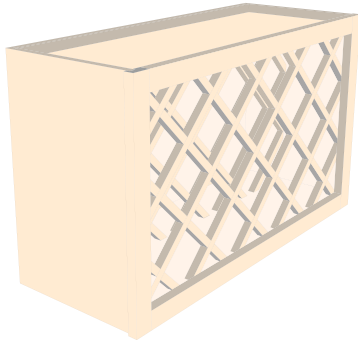

Standard Module

Wine Rack

D= 12"
XX = 18" / 24"(Optional Height)
WR 30 XX (width 30")
WR 33 XX (width 33")

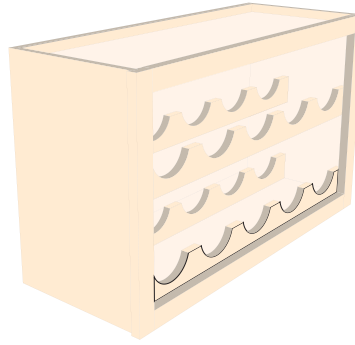

Standard Module

Wine Rack

D= 12"
XX = 18" / 24"(Optional Height)
WR 30 XX (width 30")
WR 33 XX (width 33")



ACCESSORIES

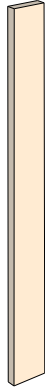

FILLER

F 330 (Width 3", Height 30")
 F 430 (Width 4", Height 30")
 F 342 (Width 3", Height 42")

F 442 (Width 4", Height 42")
 F 396 (Width 3", Height 96")

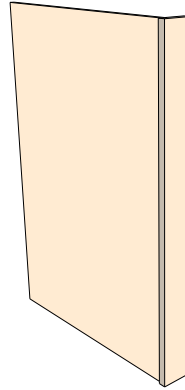

BASE END PANEL or DISHWASHER END PANEL

D = 24", H = 34 - 1/2"
 BEP 1 - 1/2 (Width 1 - 1/2")
 BEP 3 (Width 3")

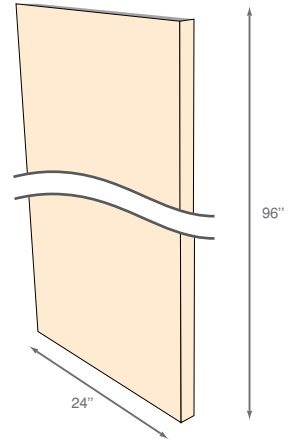

REFRIGERATOR PANEL

RP 2496 (Depth 24", Height 96", Thickness 5/8")

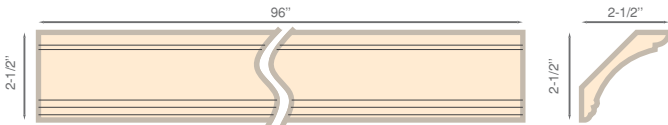

CROWN MOULDING

A Crown 2

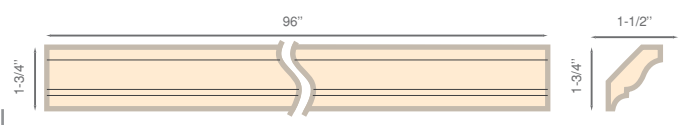

CROWN MOULDING

M Crown 8



PLASTIC LEG

Plastic Leg

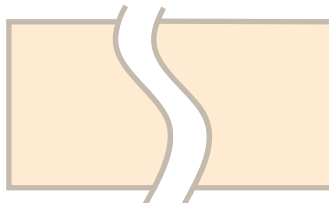

TOEKICK PANEL

W x H = 96" x 4-1/2", Thickness = 1/2"

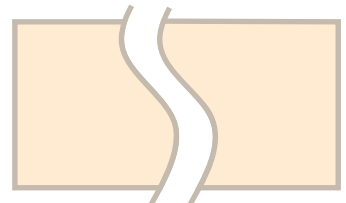

TOEKICK SKIN

W x H = 96" x 4-1/2", Thickness = 1/4"



4" ALUMINIUM PVC TOE KICK



Front View

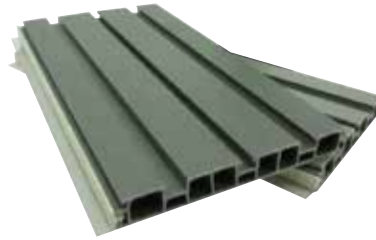

Back View



Easy to Assemble
with plastic adjustable leg

Specification

- Length 157.5" (4000 mm)
- Width 4.5" (114 mm)
- Material PVC
- Color Aluminium Brushed

Colors



620W



650A



620S



660Y



620G



610A



660B

PULL-OUT WASTE BIN



Product Features:

- Load capacity of each bin:
7.40 gallon (28 Liters)
- Product size (each plastic bin):
9-1/4" (W) x 18-1/2" (D) x 19-11/16" (H)

SINGLE BIN

Suitable for B12 (Faceframe Cabinet)

Top View:

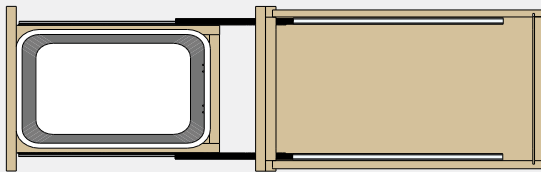

Side View:

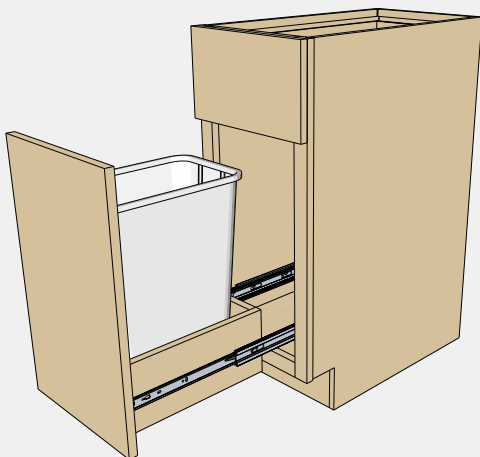

DOUBLE BIN

Suitable for B18 (Faceframe Cabinet)

Top View:

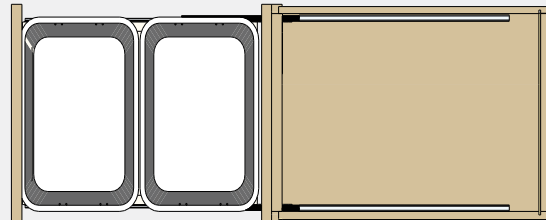

Side View:

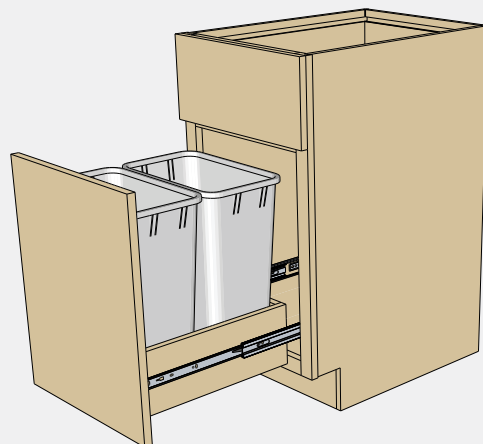



**MOVEABLE
ISLANDS**

MOVABLE ISLAND

TYPE 1 (MI 1000 4822)



◀ View 1



View 2 ▶

Dimensions

Item Code	Length	Depth	Height
MI 1000 4822	48"	22"	34-1/2"

Features

- Knockdown movable island

MOVABLE ISLAND

TYPE 2 (MI 2000 6128)



◀ View 1



View 2 ▶

Dimensions

Item Code	Length	Depth	Height
MI 2000 6128	61"	28"	34-1/2"

Features

- Knockdown movable island
- 2 front drawer



**STAND ALONE
VANITIES**

VANITY

TYPE 1 (V 1000 4221)



Dimensions

Item Code	Length	Depth	Height
V 1000 4221	42"	21"	32-1/2"

TYPE 2 (V 2000 5423)



Dimensions

Item Code	Length	Depth	Height
V 2000 5423	54"	23"	32-1/2"

VANITY

TYPE 3 (V 3000 4821)



Dimensions

Item Code	Length	Depth	Height
V 3000 4821	48"	21"	32-1/2"

TYPE 4 (V 4000 5121)



Dimensions

Item Code	Length	Depth	Height
V 4000 5121	51"	21"	32-1/2"



COUNTERTOPS

GRANITE

Group A

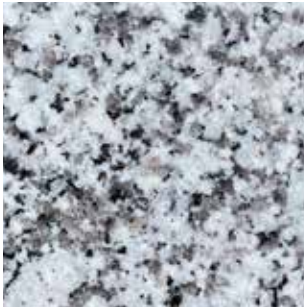

Capri Gray

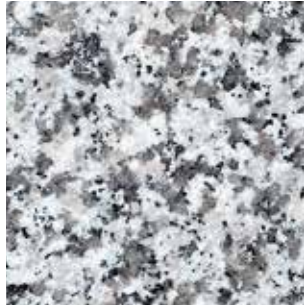

Snow Gray



Jilin White



Swan White

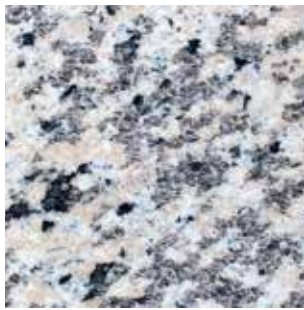

Tiger Skin White



Rice White

Group B



White Wave



Santa Cecilia Light

Group C



3001 - Absolute Black

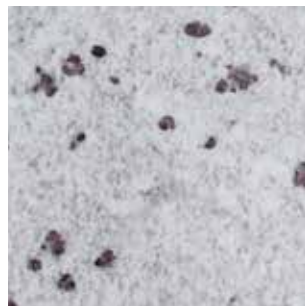

3003 - Dallas White

QUARTZ

Group A

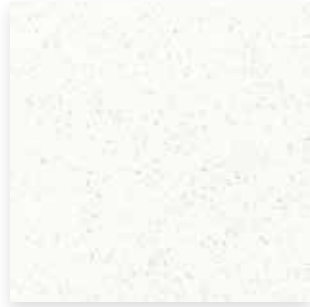

7008 - Premium White



7009 - Frost White



7045 - Nugget White



7850 - Alpine White

Group B



3032 - Sandbar Grey



6502 - Pebble

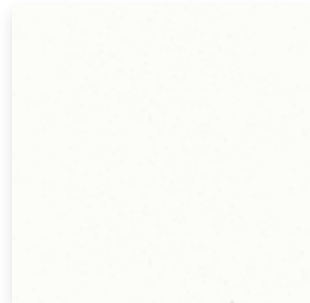

7028 - Pure White



7304 - Black Alta



7305 - Raven



7611 - Metropolis Grey

* The color may be slightly different due to printing
** Information about technical details and colors from this catalog may be modified or updated by the company without prior notice. Please contact us for further information

QUARTZ

Group C



6500 - Sea Storm



6501 - Carrara White



6503 - Stevra



6504 - Argento Brown



6505 - Grey Sayoe



7306 - Clamshell

Group D



6001
Calacatta Summer White



6002
Calacatta Summer Black



6003 - Chopin



6004 - Swan Lake



6506 - Sky Grey

NOTE: Laminate colors available

* The color may be slightly different due to printing
 ** Information about technical details and colors from this catalog may be modified or updated by the company without prior notice. Please contact us for further information



CABINET HARDWARE

HINGES

Compact Hinges Standard



TD 1212 0012

- 1/2" overlay;
- Cup hole diameter 35 mm;
 - Hinge cup premounted with 2 pcs of 8 mm dowels
 - 105 degree
 - 6 way adjustment



TD 1212 0100

- 1" overlay;
- Cup hole diameter 35 mm;
 - Hinge cup premounted with 2 pcs of 8 mm dowels
 - 105 degree
 - 6 way adjustment



TD 1212 0114

- 1-1/4" overlay;
- Cup hole diameter 35 mm;
 - Hinge cup premounted with 2 pcs of 8 mm dowels
 - 105 degree
 - 6 way adjustment

Compact Hinges Soft Closed



TD 1215 0012

- 1/2" overlay;
- Cup hole diameter 35 mm;
 - Hinge cup premounted with 2 pcs of 8 mm dowels
 - 105 degree
 - 6 way adjustment

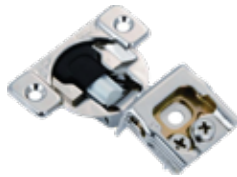

TD 1215 0100

- 1" overlay;
- Cup hole diameter 35 mm;
 - Hinge cup premounted with 2 pcs of 8 mm dowels
 - 105 degree
 - 6 way adjustment

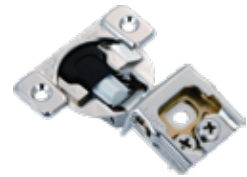

TD 1215 0114

- 1-1/4" overlay;
- Cup hole diameter 35 mm;
 - Hinge cup premounted with 2 pcs of 8 mm dowels
 - 105 degree
 - 6 way adjustment

Long Arm Standard



TD 1240 1014

- Full overlay clip-on hinge with dowels;
- 105 degree
 - 6-way adjustment



TD 1942 0001 (0mm)

Fully adjustable alloy mounting plate



TD 1942 1002 (0mm)
TD 1942 1022 (2mm)
TD 1942 1042 (4mm)

Euro mounting plate with euro screws

Long Arm Soft Closed



TD 1000 0014

- Full overlay;
- Soft Closing Hinge with 8 mm dowels
 - 110 degree



TD 1941 1001 (0m/m)

Fully Adjustable Soft Closing Plate

HANDLES

Finishes



Satin Nickel



Polished Chrome



Venetian Bronze

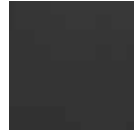

Matte Black



Gold

Contemporary Handles



ITEM CODE	LENGTH
CH 2209 1096	6 - 1/8"
CH 2209 1128	7 - 1/2"
CH 2209 1160	8 - 3/4"
CH 2209 1192	10 - 3/4"



ITEM CODE	LENGTH
CH 2265 1096	4 - 3/4"
CH 2265 1128	6"
CH 2265 1160	7 - 1/2"
CH 2265 6096	4 - 3/4"
CH 2265 6128	6"
CH 2265 6160	7 - 1/2"



ITEM CODE	LENGTH
CH 2270 1096	4 - 1/8"
CH 2270 1128	5 - 3/8"
CH 2270 1160	6 - 5/8"
CH 2270 6096	4 - 1/8"
CH 2270 6128	5 - 3/8"
CH 2270 6160	6 - 5/8"

Modern Handles



ITEM CODE	LENGTH
CH 2277-1096	4 - 3/4"
CH 2277-1128	6"
CH 2277-1160	7 - 1/2"
CH 2277-2096	4 - 3/4"
CH 2277-2128	6"
CH 2277-2160	7 - 1/2"
CH 2277-6096	4 - 3/4"
CH 2277-6128	6"
CH 2277-6160	7 - 1/2"
CH 2277-7096	4 - 3/4"
CH 2277-7128	6"
CH 2277-7160	7 - 1/2"



ITEM CODE	LENGTH
CH 2279-1096	4 - 3/4"
CH 2279-1128	6"
CH 2279-1160	7 - 1/2"
CH 2279-2096	4 - 3/4"
CH 2279-2128	6"
CH 2279-2160	7 - 1/2"
CH 2279-6096	4 - 3/4"
CH 2279-6128	6"
CH 2279-6160	7 - 1/2"
CH 2279-7096	4 - 3/4"
CH 2279-7128	6"
CH 2279-7160	7 - 1/2"



ITEM CODE	LENGTH
CH 2231-1128	6 - 1/8"
CH 2231-2128	7 - 1/2"
CH 2231-7128	8 - 3/4"
CH 2231-6128	10 - 3/4"

Traditional Handles



ITEM CODE	LENGTH
CH 2208 1096	5 - 1/2"
CH 2208 1128	7"
CH 2208 3096	5 - 1/2"
CH 2208 3128	7"
CH 2208 4096	5 - 1/2"
CH 2208 4128	7"



ITEM CODE	LENGTH
CH 2200 1096	5 - 1/2"
CH 2200 1128	7"
CH 2200 3096	5 - 1/2"
CH 2200 3128	7"
CH 2200 6096	5 - 1/2"
CH 2200 6128	7"



* the color might be different due to printing process

KNOBS



ITEM CODE	LENGTH
CH 2106 1000	1 - 1/4"
CH 2106 3000	1 - 1/4"
CH 2106 6000	1 - 1/4"

ITEM CODE	LENGTH
CH 2102 1000	1 - 1/4"
CH 2102 3000	1 - 1/4"
CH 2102 6000	1 - 1/4"

Hollow Knobs

CH 2106 1001	1 - 1/4"
CH 2106 3001	1 - 1/4"

DRAWER SLIDES

Full Extension Ball bearing Slides



TD 2200 1002

Rear Bracket

TD 2200 1003

Self Adjusting Rear Bracket

Item Code	Description
TD 2210 1025	10" Full Extension Ball Bearing Drawer Slide (1.0/1.0/1/2mm)
TD 2210 1230	12" Full Extension Ball Bearing Drawer Slide (1.0/1.0/1/2mm)
TD 2210 1435	14" Full Extension Ball Bearing Drawer Slide (1.0/1.0/1/2mm)
TD 2210 1640	16" Full Extension Ball Bearing Drawer Slide (1.0/1.0/1/2mm)
TD 2210 1845	18" Full Extension Ball Bearing Drawer Slide (1.0/1.0/1/2mm)
TD 2210 2050	20" Full Extension Ball Bearing Drawer Slide (1.0/1.0/1/2mm)
TD 2210 2255	22" Full Extension Ball Bearing Drawer Slide (1.0/1.0/1/2mm)
TD 2210 2460	24" Full Extension Ball Bearing Drawer Slide (1.0/1.0/1/2mm)

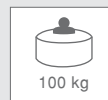

Features

Side mounted full extension, 1-1/4" hole system steel ball bearings, lock action when closed, released lever

Material

Work hardened cold rolled steel

Full Extension Ballbearing Slides (Soft Closing)



Item Code	Description
TD 2220 1435	14" Full Extension Ball Bearing Drawer Slide (soft closing)
TD 2220 1640	16" Full Extension Ball Bearing Drawer Slide (soft closing)
TD 2220 1845	18" Full Extension Ball Bearing Drawer Slide (soft closing)
TD 2220 2050	20" Full Extension Ball Bearing Drawer Slide (soft closing)
TD 2220 2255	22" Full Extension Ball Bearing Drawer Slide (soft closing)



Length	18", 20", 22"
Height	2.1"
Side Space	0.75"
Carrying Capacity	220 lbs (100 kg)
Finishing	Clear zinc plating, Black E-coating

Soft Close Undermount Slides



Description:

- Full extension slide completely hidden under the drawer
- Soft Close feature automatically engages the drawer and brings it to a swift, soft and quiet close
- 100lbs dynamic load capacity guaranteed to surpass all ANSI, BHMA & KCMA test
- works in a wide variety of applications: face frame, frameless (European), overlay & inset cabinets for drawers up to 5/8" max. drawer side thickness
- Left and right release clip included, featuring toolless height adjustment and easy insertion and removal.

Item Code	Overall Cabinet Depth	Overall Drawer Length	Frameless Min. Inside Cabinet Depth	Face Frame Min. Inside Cabinet Depth	Face Frame Max. Inside Cabinet Depth
TD 2311 1538	18"	15"	16"	16"	17-1/2"
TD 2311 1845	21"	18"	19"	19"	20-1/2"

Description Components :



Clip Locking Device

Include with undermounting slide

- One right and one left required per drawer
- Minimum inside drawer width 121(4-3/4")
- Height adjustable + (1/8")



TD 2304 1001

Plastic Bracket Adjustable

- Bracket provides wide range of lateral self-alignment features
- Non-handed, two piece design
- Dowels plug into pre-drilled 5/16" system holes
- Heavy-duty all plastic construction
- Slot in slide allows for 1-5/8" depth adjustment
- Face frame cabinets application



TD 2300 1002

Steel Rear Mounting Bracket for Face Frame Cabinets

Note:

1. These runners are for 5/8" maximum drawer side thickness, assume 5/32" (setback from drawer opening)
2. Rear brackets for face frame applications will yield a 3/16" - 1-7/8" depth adjustment
3. For inset drawer front application. Setback: 3/16" + drawer front thickness
4. For frameless cabinets, inside cabinet depth minimum = slide length + setback + 1/8"
5. For face frame cabinets, inside cabinet depth minimum = slide length + setback + 3/16"
6. For face frame cabinets, inside cabinet depth maximum = slide length + setback + 1-5/16"



SINK & FAUCET

KITCHEN SINK

Top Mount Sink



AS 2522

Outside size: 25" x 22" | Inside size: 21-1/4" x 15-1/10"

Features:

- Premium grade 304 stainless steel
- 8" depth*18 gauge (standard)
- 5-1/2" depth*18 gauge(handicap)
- Lustrous satin
- 3-1/2" drain opening
- Fully enclosed bottom for intensive use with a sound-insulating lining



AS 3322

Outside size: 33" x 22" | Inside size: 14" x 16" x 2 bowls

Features:

- Premium grade 304 stainless steel
- 10" depth*18 gauge, 4 holes
- Lustrous satin
- 3-1/2" drain opening
- Fully enclosed bottom for intensive use with a sound-insulating lining

Under Mount Sink



AS 2318

Outside size: 23-3/8" x 17-3/4"

Inside size: 21-3/8" x 15-3/4"

Features:

- Premium grade 304 stainless steel
- 9" depth*18 gauge
- Lustrous satin
- 3-1/2" drain opening
- Fully enclosed bottom for intensive use with a sound-insulating lining



AS 3018

Outside size: 29-7/8" x 18-1/16"

Inside size: 27-3/4" x 15-1/16"

Features:

- Premium grade 304 stainless steel
- 9" depth*18 gauge
- Lustrous satin
- 3-1/2" drain opening
- Fully enclosed bottom for intensive use with a sound-insulating lining



AS 3018 ADA

Outside size: 29-7/8" x 18-1/16"

Inside size: 27-3/4" x 15-1/16"

Features:

- Premium grade 304 stainless steel
- 5-1/2" depth*18 gauge (handicap)
- Lustrous satin
- 3-1/2" drain opening
- Fully enclosed bottom for intensive use with a sound-insulating lining



AS 3318

Outside size: 32-1/2" x 18-1/4"

Inside size: 14-1/2" x 16" x 2 bowls

Features:

- Premium grade 304 stainless steel
- 9" depth*18 gauge
- Lustrous satin
- 3-1/2" drain opening
- Fully enclosed bottom for intensive use with a sound-insulating lining



AS 3221 - L/R 60:40

Outside size: 31-3/4" x 20-1/2"

Inside size: 15-1/2" x 18-1/2" & 12-7/8" x 16-1/2"

Features:

- Premium grade 304 stainless steel
- 9" depth (big bowl), 8" depth (small bowl)*18 gauge
- Lustrous satin
- 3-1/2" drain opening
- Fully enclosed bottom for intensive use with a sound-insulating lining



AS 3222 - L/R 70:30

Outside size: 31-1/2" x 20-1/2"

Inside size: 17-1/2" x 18-1/2" & 10-1/2" x 16-5/8"

Features:

- Premium grade 304 stainless steel
- 9" depth (big bowl), 7" depth (small bowl)*18 gauge
- Lustrous satin
- 3-1/2" drain opening
- Fully enclosed bottom for intensive use with a sound-insulating lining



AS 3018 SQ

Outside size: 30" x 18"

Inside size: 28" x 16"

Features:

- Premium grade 304 stainless steel
- 9" depth*18 gauge
- Zero corner
- Handmade stain, brush finish
- 3-1/2" drain opening



AS 3318 SQ

Outside size: 33" x 18"

Inside size: 15" x 16" x 2 bowls

Features:

- Premium grade 304 stainless steel
- 9" depth*18 gauge
- Zero corner
- Handmade stain, brush finish
- 3-1/2" drain opening

Farm / Apron Sink



AS 2520 AP

Outside size: 25" x 20"
 Inside size: 23" x 16-3/4"

Features:

- Premium grade 304 stainless steel
- 9" depth*16 gauge
- Zero corner
- Handmade stain, brush finish
- 3-1/2" drain opening



AS 3320 AP

Outside size: 32-7/8" x 20-3/4"
 Inside size: 30" x 16"

Features:

- Premium grade 304 stainless steel
- 9" depth*18 gauge
- Zero corner
- Handmade stain, brush finish
- 3-1/2" drain opening



AS 3620 AP

Outside size: 35-7/8" x 20-3/4"
 Inside size: 19" x 16" (l) & 13" x 16" (r)

Features:

- Premium grade 304 stainless steel
- 9" depth*16 gauge
- Zero corner
- Handmade stain, brush finish
- 3-1/2" drain opening

VANITY SINK

Under Mount Sink



LUNA 1714

Outside size: 19-1/4" x 15-3/4" x 8-1/16"
 Inside size: 17-3/8" x 14-1/8" x 6-3/4"
 Material: porcelain



MONZA 1813

Outside size: 19-7/8" x 14-13/16" x 7-3/16"
 Inside size: 17-5/8" x 12-3/8" x 5-3/4"
 Material: porcelain



ALPINE 1912

Outside size: 20-5/8" x 14-3/16" x 6-1/16"
 Inside size: 18-1/2" x 11-13/16" x 5-1/2"
 Material: porcelain



Kitchen Faucet



AS 1202 2000 (Brushed Nickel)
AS 1202 3000 (Chrome)

- Features:
- 8" dual handle faucet
 - Hybrid waterway
 - Washerless cartridge
 - Without spray



AS 1204 2000 (Brushed Nickel)
AS 1204 3000 (Chrome)

- Features:
- 17" height pull-down faucet
 - Black nylon spray hose
 - Metal lever handle
 - Ceramic cartridge
 - With 3/8 female thread stainless steel compression hose as inlet tube



AS 1214 2000 (Brushed Nickel)
AS 1214 3000 (Chrome)

- Features:
- 17" height spring faucet
 - Stainless steel spray hose
 - Metal lever handle
 - Ceramic cartridge
 - With 1/2 male thread cooptube as inlet tube



AS 1216 2000 (Brushed Nickel)
AS 1216 3000 (Chrome)

- Features:
- 10.7" height pull-out faucet
 - Black nylon spray hose
 - Metal lever handle
 - Ceramic cartridge
 - With 3/8 female compression stainless steel hose as inlet tube with deckplate



AS 1219 2000 (Brushed Nickel)
AS 1219 3000 (Chrome)

- Features:
- Metal single handle pullout
 - Ceramic cartridge
 - Stainless steel shower hose
 - 1/2 male copper tube as inlet tube with deckplate

Vanity Faucet



AS 1103 2000 (Brushed Nickel)
AS 1103 3000 (Chrome)

- Features:
- 4" two Handle
 - Hybrid waterway
 - Washerless cartridge
 - Metal lever handle
 - With ABS pop-up



AS 1105 2000 (Brushed Nickel)
AS 1105 3000 (Chrome)

- Features:
- 4" single handle
 - Hybrid waterway
 - Washerless cartridge
 - With ABS pop-up



AS 1116 2000 (Brushed Nickel)
AS 1116 3000 (Chrome)

- Features:
- Metal single handle
 - Ceramic cartridge
 - 150mm height
 - With ABS pop-up



AS 1117 2000 (Brushed Nickel)
AS 1117 3000 (Chrome)

- Features:
- 8" widespread faucet
 - Metal lever handle
 - Ceramic cartridge
 - With ABS pop-up



AS 1118 2000 (Brushed Nickel)
AS 1118 3000 (Chrome)

- Features:
- 210mm height
 - Ceramic cartridge
 - With 3/8 female compression stainless steel hose as inlet tube with deckplate



AS 1121 2000 (Brushed Nickel)
AS 1121 3000 (Chrome)

- Features:
- Single handle faucet
 - Metal lever handle
 - Ceramic cartridge
 - With 3/8 female compression stainless steel hose as inlet tube
 - With a small hat press brass pop-up



WOODSIDE MILL
Greenville, South Carolina



**VILLAGE
AT COMMONWEALTH**
Charlotte, North Carolina



BAINBRIDGE SOUTH END
Charlotte, North Carolina



**THE STATION AT
SAVANNAH QUARTERS**
Pooler, Georgia



THE REEVE NASHVILLE
Nashville, Tennessee



PEABODY 1
Atlanta, Georgia



4261 Communications Drive
Norcross, GA 30093, USA

☎ 1-877-374-6782

✉ astera@youngcorporation.com



10888 San Sevaive Way Unit F
Jurupa Valley, CA 91752, USA

☎ 1-323-721-4200

✉ astera@youngcorporation.com



7510 American Way
Groveland, FL 34736, USA

☎ 1-877-374-6782

✉ astera@youngcorporation.com



88 Konrad Crescent #2
Markham, ON L3R 8T7, Canada

☎ 1-905-477-8842

✉ astera@youngcorporation.com



16-20 Williams Way
Wollaston Industrial Estate
Wollaston, Wellingborough,
Northamptonshire,
NN29 7RQ, United Kingdom

☎ 44-1933-667447

✉ sales@asterakb.com



Rukan Great Wall C No. 35
Gondrong, Cipondoh,
Kota Tangerang, Banten 15147
Indonesia

☎ 62-21-2903-8258

✉ sales@astera.co.id



Ruko Prominence 38F No. 41-42,
Alam Sutera, Kec. Pinang, Kota Tangerang,
Banten 15143

✉ sales@homestyle.co.id



Jl. Sunset Road No.85 X,
Seminyak, Kec. Kuta, Kabupaten
Badung, Bali 80361

🌐 www.homestyle.co.id

✉ sales@homestyle.co.id



Division of YOUNG CORPORATION

